



# ROOF FIRE DEPT. OUTLET CONNECTIONS

**REGULARLY FURNISHED:** Cast brass body with female N.P.T. inlet and male N.P.T. outlets. Type and size of inlet and number of outlets as selected by Figure Number.

**VARIATION:** ☐ —M with male hose thread, specify thread

## TWO-WAY-MALE OUTLETS

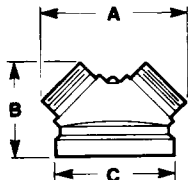

☐ Fig. 5870 Series ..... Back Inlet

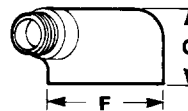
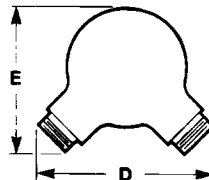

☐ Fig 5875 Series ..... Angle Inlet

Inlet Location				Inlet Size	Outlet Size	A	B	C	D	E	F	G
✓	Back Fig. No.	✓	Angle Fig. No.									
	5871		5876	4	2½	7	5	5	7	6	5	5
	5872		5877	6	2½	9	7	7½	10	8	7½	5
	5873		5878	4	3	8½	7	5¾	9	6½	4¾	5¼
	5874		5879	6	3	9½	8½	7½	10¼	8½	7½	5¼

ALL DIMENSIONS IN INCHES

## THREE-WAY-MALE OUTLETS

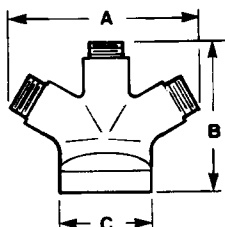

☐ Fig. 5880 Series ..... Back Inlet

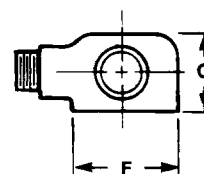
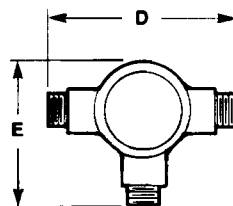

☐ Fig 5885 Series ..... Angle Inlet

Inlet Location				Inlet Size	Outlet Size	A	B	C	D	E	F	G
✓	Back Fig. No.	✓	Angle Fig. No.									
	5881		5886	4	2½	11	9	5¼	8¾	7½	5¼	5
	5882		5887	6	2½	11¾	9½	7½	11¾	9½	7½	5
	5883		5888	4	3	12¾	8¾	5¼	12¼	9¾	7½	5
	5884		5889	6	3	14¾	9¾	7½	11¾	9¾	7½	5

ALL DIMENSIONS IN INCHES

## THREE-WAY-FEMALE OUTLETS

☐ Fig. 5890  
4" Female  
N.P.T. Both Ends  
With 2½" N.P.T.  
Outlets

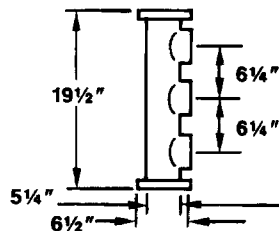

☐ Fig. 5892  
6" Female  
N.P.T. Both Ends  
With 2½" N.P.T.  
Outlets

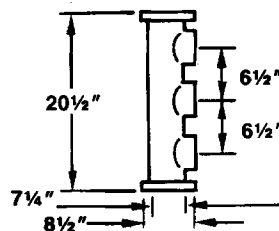

DATE  
7-19-95

FIGURE NUMBER

**5870-5892**